

APR 25 1995 *slp* SYNCHRONIZATION OF GRADE CROSSING TRAFFIC CONTROL DEVICES AND FUTURE RESPONSIBILITY

COUNTY	SECTION	JOB NUMBER	ROAD NAME OR NUMBER	COUNTY NAME	PARCEL & R/W NUMBER	FAP NUMBER
75	010	6521	SR 500-600 US 441 & 17-92	Orange	1 (2102)	F-399-3 (22)

A RESOLUTION AUTHORIZING EXECUTION OF A RAILROAD REIMBURSEMENT AGREEMENT FOR THE SYNCHRONIZATION OF GRADE CROSSING TRAFFIC CONTROL DEVICES, AND FUTURE MAINTENANCE AND ADJUSTMENT OF SAID DEVICES; PROVIDING FOR THE EXPENDITURE OF FUNDS AND PROVIDING WHEN THIS RESOLUTION SHALL TAKE EFFECT.

RESOLUTION NO. 95-M-28

ON MOTION OF Commissioner _____,
seconded by Commissioner _____,
the following RESOLUTION was adopted:

WHEREAS, the State of Florida Department of Transportation is constructing, reconstructing or otherwise changing a portion of the Public Road System, on SR 500-600/US 441 & 17-92, which shall call for the installation and maintenance of railroad synchronization of grade crossing traffic control devices for railroad grade crossing over or near said highway; and

NOW, THEREFORE, BE IT RESOLVED BY THE COUNTY COMMISSION OF
Orange COUNTY, FLORIDA;

That Orange County enter into a RAILROAD REIMBURSEMENT AGREEMENT with the STATE OF FLORIDA DEPARTMENT OF TRANSPORTATION and the CSX Transportation, Inc. Company for the installation and maintenance of certain traffic control devices designated as Job No. 75010-6521 on SR 500-600/US 441 & 17-92 which crosses the right of way and tracks of the Company at FDOT/AAR Crossing No. 622326-J located near Orlando, Florida; and

That the County assume responsibility for future maintenance and adjustment of said traffic control devices as designated in the RAILROAD REIMBURSEMENT AGREEMENT FOR SYNCHRONIZATION; and

That the Chairman and Clerk of the Board of County Commissioners be authorized to enter into such agreements with the STATE OF FLORIDA DEPARTMENT OF TRANSPORTATION and the CSX Transportation, Inc. Company as herein described; and

That this RESOLUTION shall take effect immediately upon adoption.

INTRODUCED AND PASSED by the Board of County Commissioners of Orange County, Florida, in regular session this 25th day of April, 1995.

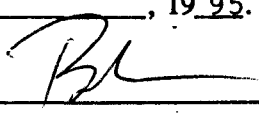

Bob Freeman ~~FOR~~ Chairman of the Board of County Commissioners

ATTEST: *[Signature]*
Clerk of the Board of County Commissioners

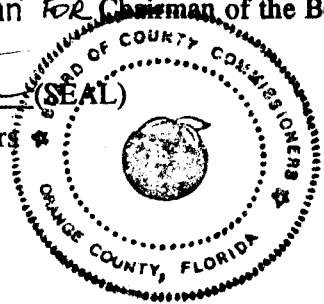



MEMORANDUM

DATE: January 14, 1992
TO: File
FROM: *R.W.W.*
Ray Woodruff
COPIES:
SUBJECT: Synchronization Estimate
CSX Transportation, Inc.

WPI No.: 5114521
Section: 75010-6521
County: Orange
Crossing No.: 622326-J

FAP No.: F-399-3(22)
State Road: 500-600/
US 441 & 17-92
Parcel No.: 1 (2102)
Railroad Milepost: 797.17

As per Mr. Jon Wollenzien this date, Synchronization for the above referenced project is estimated at \$5,000.00.

RWW/rw
5114521.EST

ORANGE COUNTY TRAFFIC SIGNAL TIMING

178

LOCATION: OBT/LANDSTREET RD.
 CONTROLLER: EPAC 300
 AUX EQUIP:

MODE:
 TIMING MODIFIED: 02/01/94
 TIMING BY: WET JR

CONTROLLER PHASE	1	2	3	4	5	6	7	8
DIRECTION	SBL	NB	EB	WB	NBL	SB		
MINIMUM GREEN	7	11	10	10	7	11		
VEHICLE EXT	3	3	3	3	3	3		
YELLOW CLEAR	3.5	4.5	4.5	4.5	3.5	4.5		
RED CLEARANCE	0.5	1	1.5	1.5	0.5	1		
MAX GREEN 1	12	65	20	25	12	65		
MAX GREEN 2								
WALK								
DON'T WALK								
PHASE RECALL/LK	NL	MIN	NL	NL	NL	MIN		
DETECTOR TIMING								
OVERLAPS WITH								
FLASHING COLOR		Y	R	R		Y		

DIAL	1	2	3	4
CYCLE LENGTH	130	140	140	
OFFSET 1 (SEC)	14	90	130	
OFFSET 2				
SPLIT 1 (SEC)	20	17	15	
SPLIT 2 (SEC)	57	73	84	
SPLIT 3 (SEC)	22	24	21	
SPLIT 4 (SEC)	31	26	20	
SPLIT 5 (SEC)	18	12	15	
SPLIT 6 (SEC)	59	78	84	
SPLIT 7 (SEC)				
SPLIT 8 (SEC)				
START PERM 1	AUTO PERMISSIVE			
END PERM 1				
START PERM 2				
END PERM 2				
START PERM 3				
END PERM 3				

T.B.C. SCHEDULE

M-F BASE PLAN: 0

TIME	DIAL	OFFSET	SPLIT	MX2
0630	1	1	1	
0900	2	1	1	
1500	3	1	1	
1900	2	1	1	
2200	FREE			

SATURDAY BASE PLAN: 1

TIME	DIAL	OFFSET	SPLIT	MX2
0900	2	1	1	
2200	FREE			

SUNDAY BASE PLAN: 2

TIME	DIAL	OFFSET	SPLIT	MX2
0900	2	1	1	
2200	FREE			

SPECIAL FUNCTIONS

DET REVERSAL	
COORD PHASE	2/6
SHORTWAY	YES
START GREEN	
START AMBER	2/6
PHASE PRE	

NOTES: CONC. TIMING, SPLIT PHASING ON SIDE STREET, INHIBIT MAX. DURING COORDINATION

 W. J. WET
 02/01/94

THIS CONTRACT PLAN SET INCLUDES:

ROADWAY PLANS
SIGNING AND PAVEMENT MARKING PLANS
SIGNALIZATION PLANS

A DETAILED INDEX APPEARS ON THE KEY SHEET
OF EACH GROUP OF PLANS

INDEX OF ROADWAY PLANS

SHEET NO.	SHEET DESCRIPTION
1	KEY SHEET
2-3	SUMMARY OF PAY ITEMS
4-5	DRAINAGE MAP
6-14	TYPICAL SECTION
15	SUMMARY OF QUANTITIES
16-19	SUMMARY OF DRAINAGE STRUCTURES
20	BOX CULVERT DATA
21	FLOOD DATA
22	REFERENCE POINTS
23	CURVE DATA
24	GENERAL NOTES
25-43	ROADWAY PLAN & PROFILES
44-50	SIDE STREET PLAN & PROFILES
51-53	SPECIAL STREET PROFILES
54-57	RAMP PLAN & PROFILES
58-78	DRAINAGE STRUCTURES
79-82	W. R. A. PLAN SHEETS
83-108	W. R. A. CROSS-SHEETS
110	STANDARD BAR SECTIONS
111-113	ROADWAY SOIL BENDING DETAILS
114-212	CROSS-SECTIONS
213-238	TRAFFIC CONTROL SHEETS

STATE OF FLORIDA
DEPARTMENT OF TRANSPORTATION

PLANS OF PROPOSED
STATE HIGHWAY

STATE PROJECT NO. 75010-3521 (FEDERAL FUNDS)
ORANGE COUNTY
STATE ROAD NO. 500 (US 441)

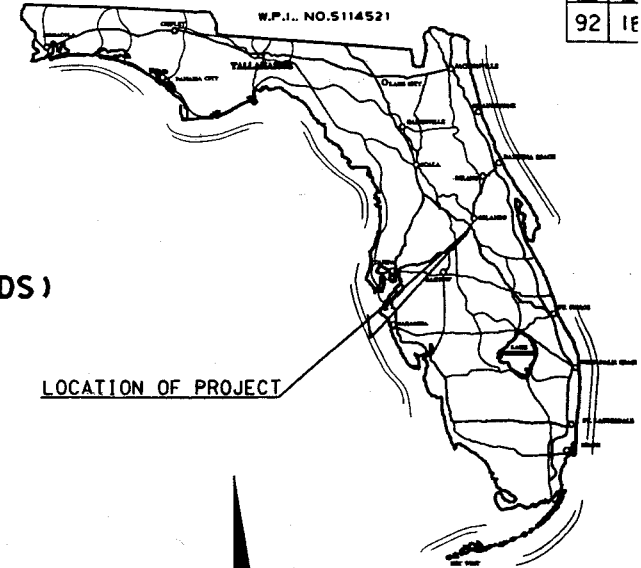

LOCATION OF PROJECT

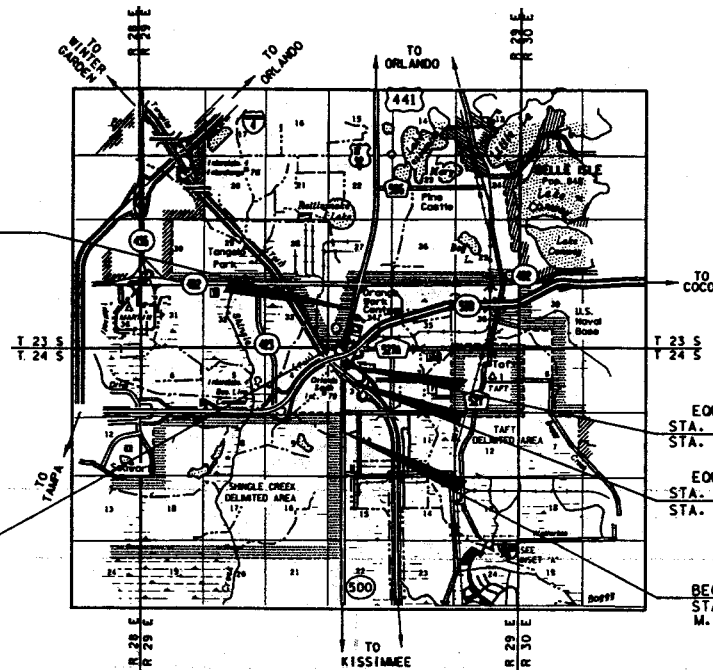

END PROJECT
STA. 357+00.00

TO COCOA

EQUATION:
STA. 303+39.25 BK
STA. 303+38.95 AH

EQUATION:
STA. 295+75.05 BK
STA. 295+75.00 AH

BEGIN PROJECT
STA. 255+23.75
M.P. 4.861

CSX TRANSPORTATION RAILROAD, INC.
CROSSING NO. 622326-J, R/R M.P. A-797.30
R.R. STA. 30+00.00

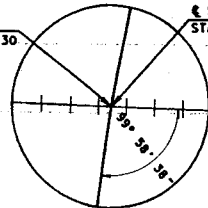

THESE PLANS HAVE BEEN PREPARED
IN ACCORDANCE WITH AND ARE GOVERNED
BY THE STATE OF FLORIDA,
DEPARTMENT OF TRANSPORTATION,
ROADWAY AND TRAFFIC DESIGN STANDARDS
(BOOKLET DATED JANUARY, 1994).

ROADWAY PLANS ENGINEER OF RECORD
GEORGE A. BORCHIK, P. E.
FLORIDA DEPARTMENT OF TRANSPORTATION
DISTRICT 5 OFFICE
719 S. WOODLAND BLVD.
DELAND, FLORIDA 32720

ATTENTION IS DIRECTED TO THE FACT THAT
THESE PLANS MAY HAVE BEEN REDUCED IN
SIZE BY REPRODUCTION. THIS MUST BE CON-
SIDERED WHEN OBTAINING SCALED DATA.

GOVERNING SPECIFICATIONS: STATE OF FLORIDA,
DEPARTMENT OF TRANSPORTATION, STANDARD
SPECIFICATIONS, DATED 1991 AND SUPPLEMENTS
THERE TO IF NOTED IN THE SPECIAL PROVISIONS
FOR THIS PROJECT.

LENGTH OF PROJECT		
	LINEAR FT.	MILES
ROADWAY	10,176.60	1.927
BRIDGES	0.00	0.000
NET LENGTH OF PROJ.	10,176.60	1.927
EXCEPTIONS	0.00	0.000
GROSS LENGTH OF PROJ.	10,176.60	1.927

PRELIMINARY

Thu Feb 9 10:47:44 1995

ROADWAY PLANS APPROVED BY: GEORGE A. BORCHIK, P. E.

DATE: _____
P.E. NO.: 0040053

PROJECT MANAGER : GEORGE A. BORCHIK, P.E.

ENGINEER : AMIR ASGARINIK

10/10/94 9:54 AM 1995
 10/10/94 9:54 AM 1995
 10/10/94 9:54 AM 1995

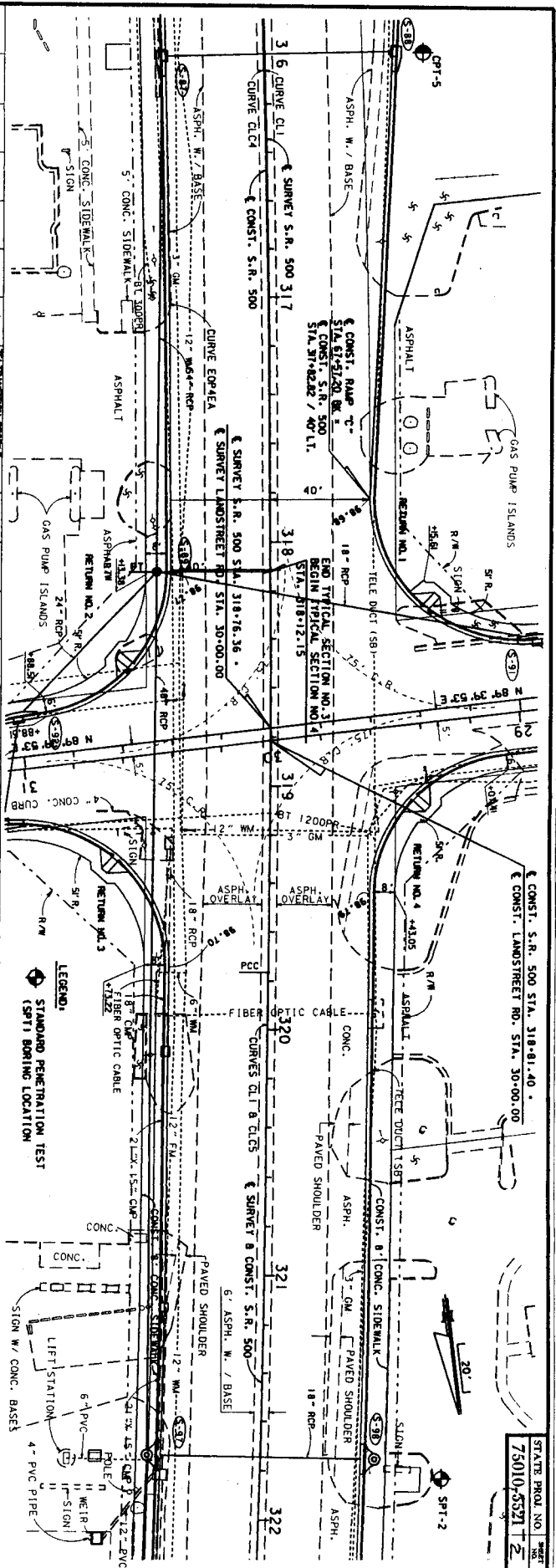
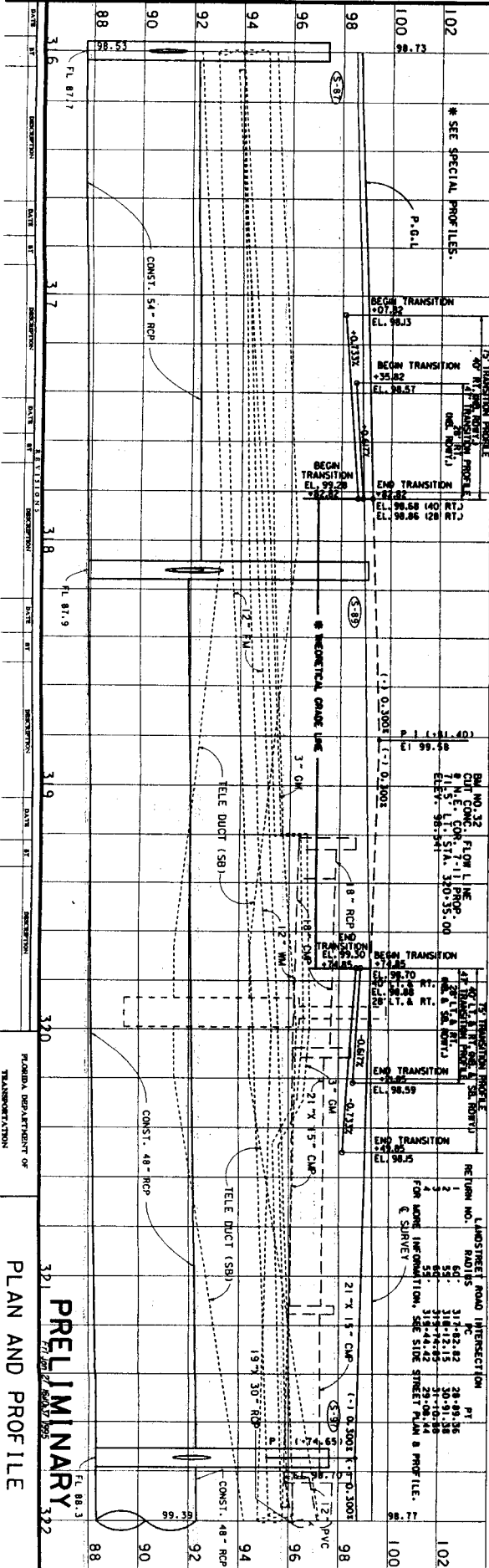

STATE PROJ. NO. 75010-5521 T-2

PRELIMINARY
 FL 88.3
 321
 322

FLORIDA DEPARTMENT OF TRANSPORTATION

PLAN AND PROFILE

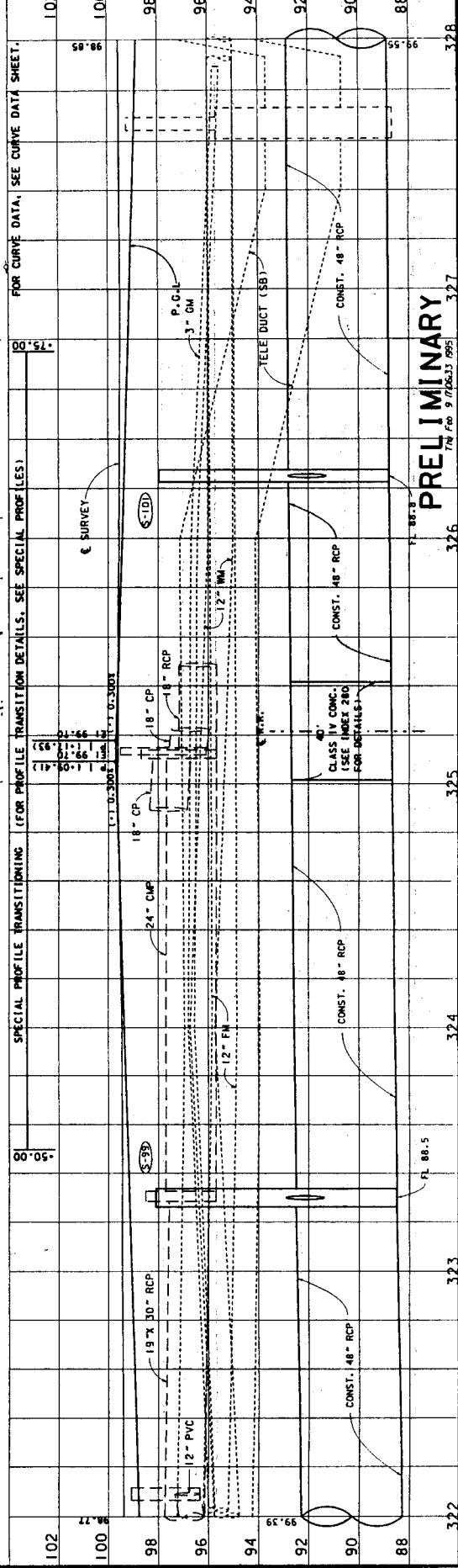
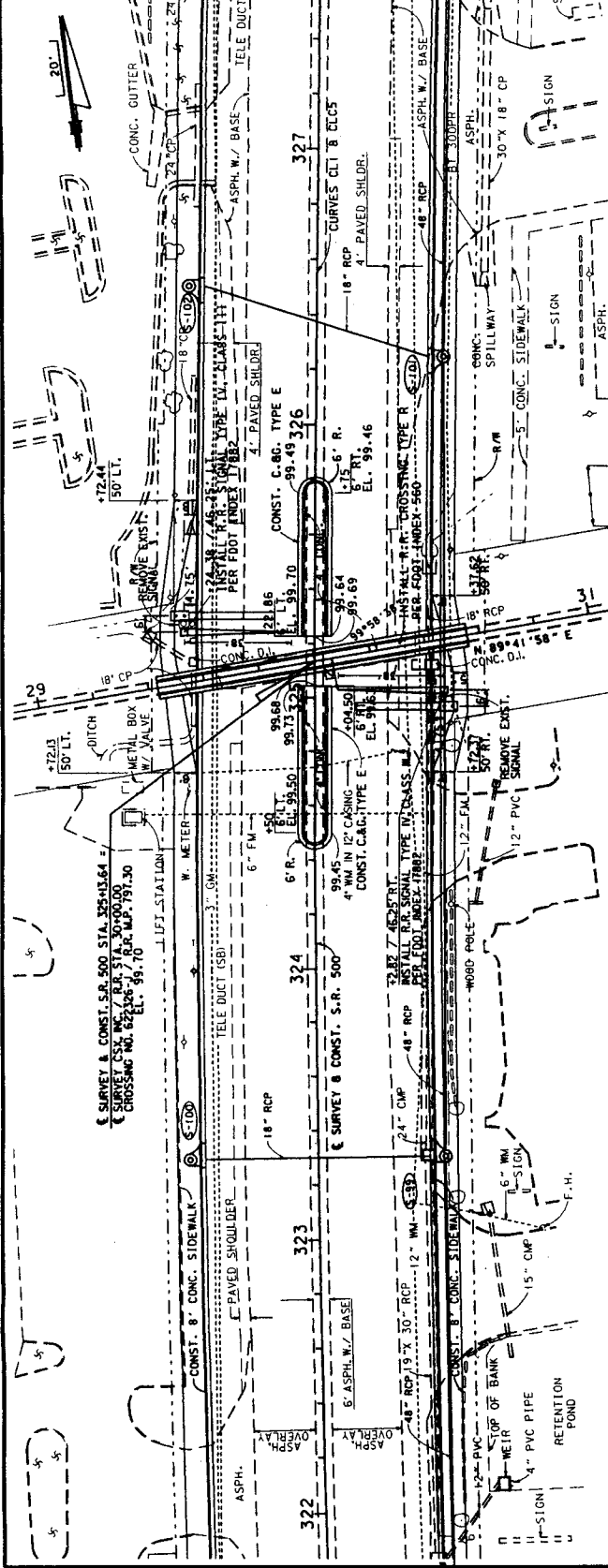

DATE BY DESCRIPTION DATE BY DESCRIPTION DATE BY DESCRIPTION DATE BY DESCRIPTION DATE BY DESCRIPTION

DATE BY DESCRIPTION DATE BY DESCRIPTION DATE BY DESCRIPTION DATE BY DESCRIPTION DATE BY DESCRIPTION

PRELIMINARY
 FL 88.5
 7/26/95
 7/26/95

FLORIDA DEPARTMENT OF
 TRANSPORTATION

PLAN AND PROFILE

SPECIAL PROFILE TRANSITIONING (FOR PROFILE TRANSITION DETAILS, SEE SPECIAL PROF LES)

FOR CURVE DATA, SEE CURVE DATA SHEET.

DATE BY DESCRIPTION DATE BY DESCRIPTION DATE BY DESCRIPTION DATE BY DESCRIPTION DATE BY DESCRIPTION

STATE OF FLORIDA
DEPARTMENT OF TRANSPORTATION

PLANS OF PROPOSED
STATE HIGHWAY

STATE PROJECT NO. 75010-3521
 ORANGE COUNTY
 STATE ROAD NO. 500

INDEX OF SIGNING AND PAVEMENT MARKING PLANS

<u>SHEET NO.</u>	<u>SHEET DESCRIPTION</u>
S-1	KEY
S-2 THRU S-4	TABULATION OF QUANTITIES
S-4	GENERAL NOTES
S-5 THRU S-16	PLAN SHEETS
S-17 THRU S-25	GUIDE SIGN CROSS-SECTION DETAIL
S-26 THRU S-29	GUIDE SIGN DETAIL WORKSHEETS

SIGNING AND PAVEMENT MARKING PLANS

THESE PLANS HAVE BEEN PREPARED
 IN ACCORDANCE WITH AND ARE GOVERNED
 BY THE STATE OF FLORIDA,
 DEPARTMENT OF TRANSPORTATION,
 ROADWAY AND TRAFFIC DESIGN STANDARDS
 (BOOKLET DATED JANUARY, 1992).

ATTENTION IS DIRECTED TO THE FACT THAT
 THESE PLANS MAY HAVE BEEN REDUCED IN
 SIZE BY REPRODUCTION. THIS MUST BE
 CONSIDERED WHEN OBTAINING SCALED DATA.

GOVERNING SPECIFICATIONS: STATE OF FLORIDA,
 DEPARTMENT OF TRANSPORTATION, STANDARD
 SPECIFICATIONS, DATED 1991 AND SUPPLEMENTS
 THERETO IF NOTED IN THE SPECIAL PROVISIONS
 FOR THIS PROJECT.

SIGNING AND PAVEMENT MARKING PLANS GEORGE A. BORCHIK, P.E.
 APPROVED BY: _____
 DATE: 00/00/00
 P.E. NO.: 40053

TPS ENGINEER: W. A. MILLER

TPS DESIGNER: S. A. BOYLAN

- 101
- 301
- 203

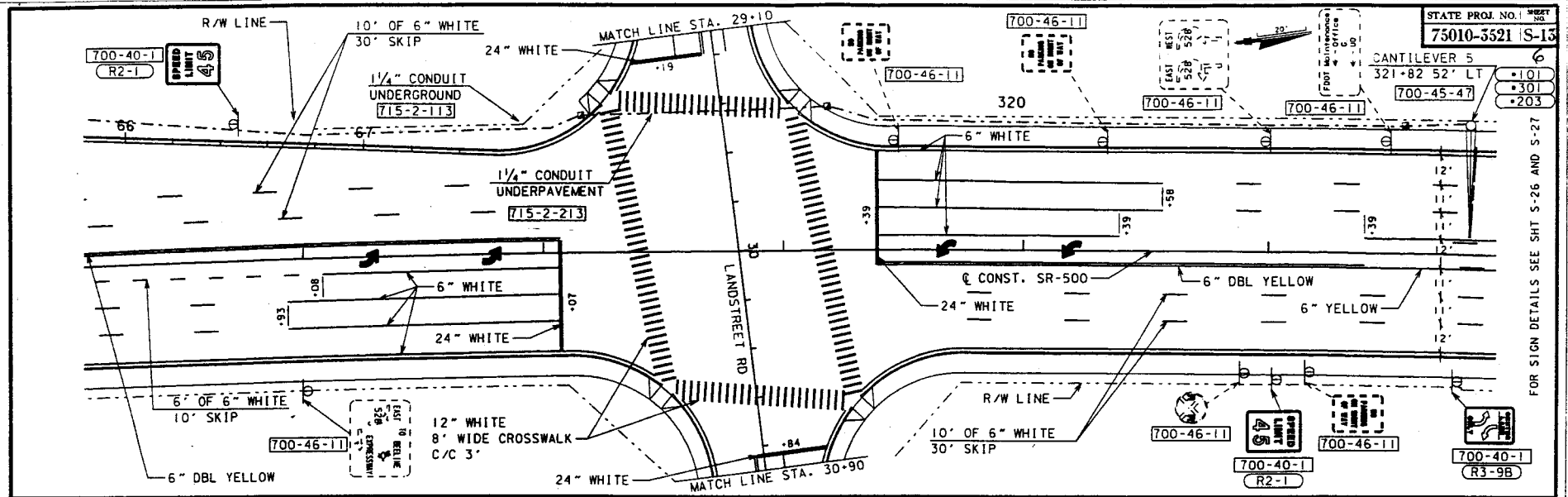

FOR SIGN DETAILS SEE SHT S-26 AND S-27

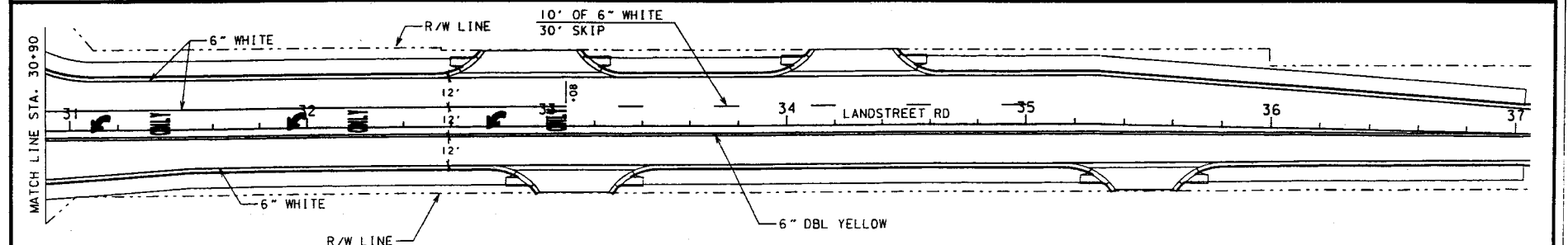

SEE SIGNAL PLANS FOR PLACEMENT OF OVERHEAD STREET NAME SIGNS
 SEE SHEET S-28 FOR SIGN DETAILS

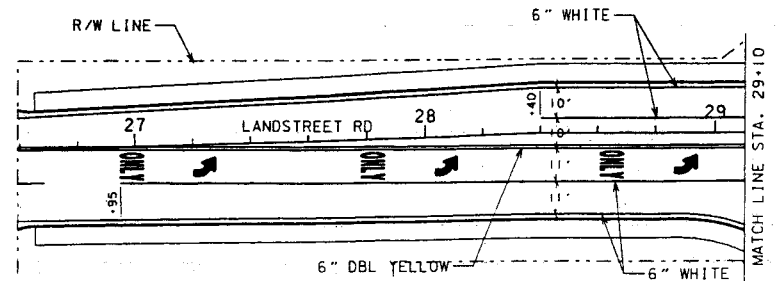

SR-500 (US-441)
 FROM TAFT-VINELAND RD
 TO SAND LAKE RD

DATE		BY		DESCRIPTION		DATE		BY		DESCRIPTION	

FLORIDA DEPARTMENT OF
 TRANSPORTATION

SIGNING & PAVEMENT MARKING PLAN

DATE PLOTTED: 11/20/00 10:52 AM

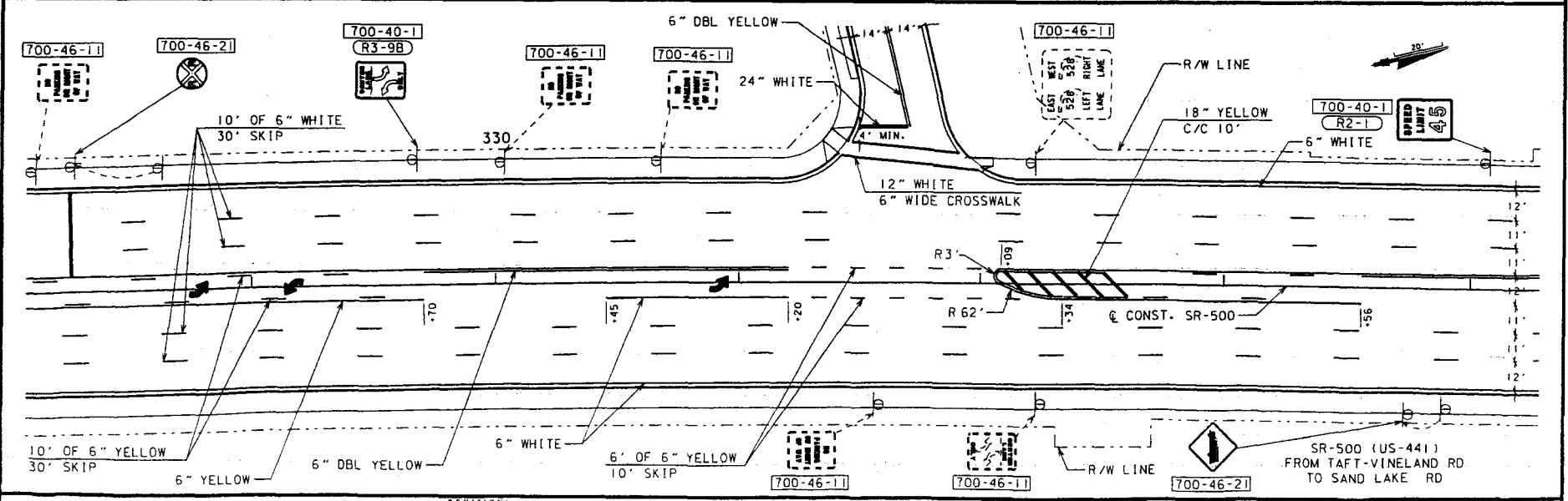
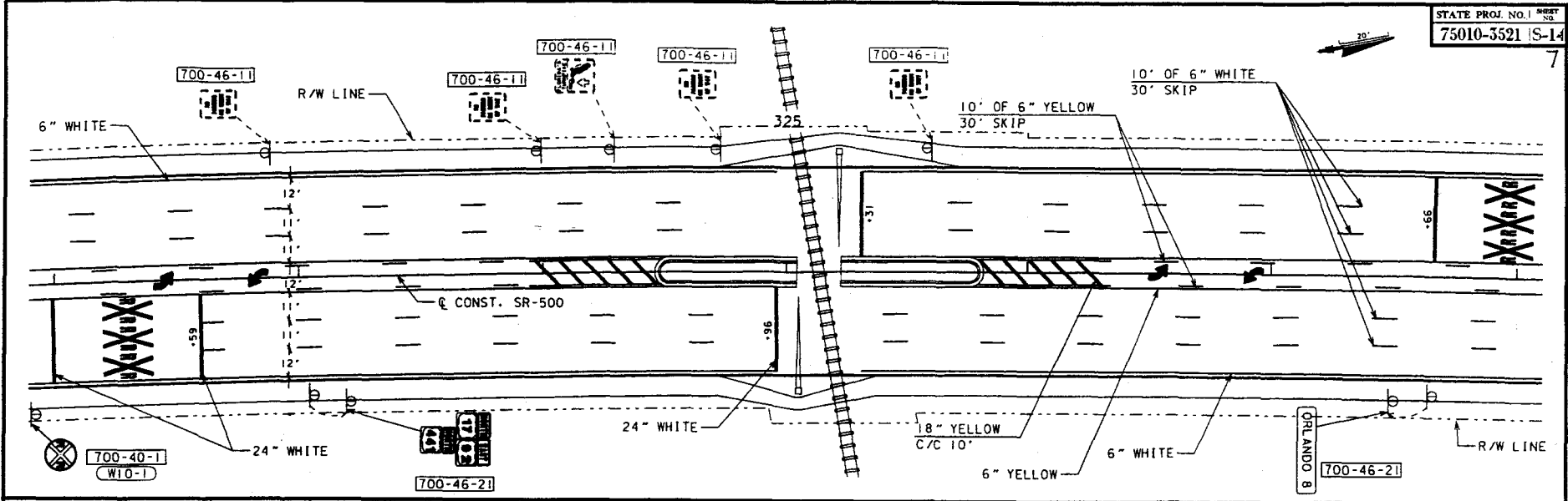

DATE	BY	DESCRIPTION	DATE	BY	DESCRIPTION	DATE	BY	DESCRIPTION	DATE	BY	DESCRIPTION

FLORIDA DEPARTMENT OF TRANSPORTATION

SIGNING & PAVEMENT MARKING PLAN

DATE: 11/15/11
BY: [Signature]
DESCRIPTION: [Signature]

**STATE OF FLORIDA
DEPARTMENT OF TRANSPORTATION**

**PLANS OF PROPOSED
STATE HIGHWAY**

STATE PROJECT NO. 75010-3521
ORANGE COUNTY
STATE ROAD NO. 500 @
TAFT VINELAND RD.
CONSULATE DR.
LANDSTREET RD.
LAQUINTA DR.
MORNING SIDE DR./ SUNLITE PATH

LOCATION OF PROJECT

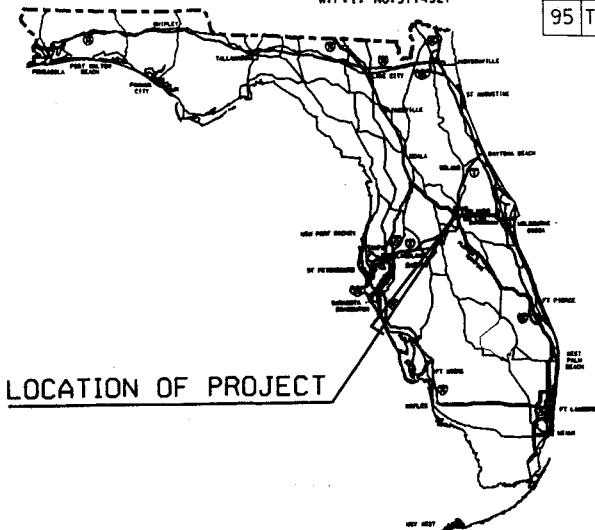

INDEX OF SIGNALIZATION PLANS

SHEET NO.	SHEET DESCRIPTION
T-1	KEY SHEET
T-2	TABULATION OF QUANTITIES
T-3	GENERAL NOTES
T-4 - T-8	SIGNALIZATION PLAN SHEETS
T-9	POLE SCHEDULE

SIGNALIZATION PLANS

THESE PLANS HAVE BEEN PREPARED IN ACCORDANCE WITH AND ARE GOVERNED BY THE STATE OF FLORIDA, DEPARTMENT OF TRANSPORTATION, ROADWAY AND TRAFFIC DESIGN STANDARDS (BOOKLET DATED JANUARY, 1934).

ATTENTION IS DIRECTED TO THE FACT THAT THESE PLANS MAY HAVE BEEN REDUCED IN SIZE BY REPRODUCTION. THIS MUST BE CONSIDERED WHEN OBTAINING SCALED DATA.
GOVERNING SPECIFICATIONS: STATE OF FLORIDA, DEPARTMENT OF TRANSPORTATION, STANDARD SPECIFICATIONS, DATED 1931 AND SUPPLEMENTS THERETO IF NOTED IN THE SPECIAL PROVISIONS FOR THIS PROJECT.

SIGNALIZATION PLANS
APPROVED BY: GEORGE A. BORCHIK P.E.
DATE: _____
P.E. NO. 40053

ENGINEER: W.A. MILLER

DESIGNER: LEROY LOVETT

75010-3521-3521-1
 1/25/34
 1/25/34

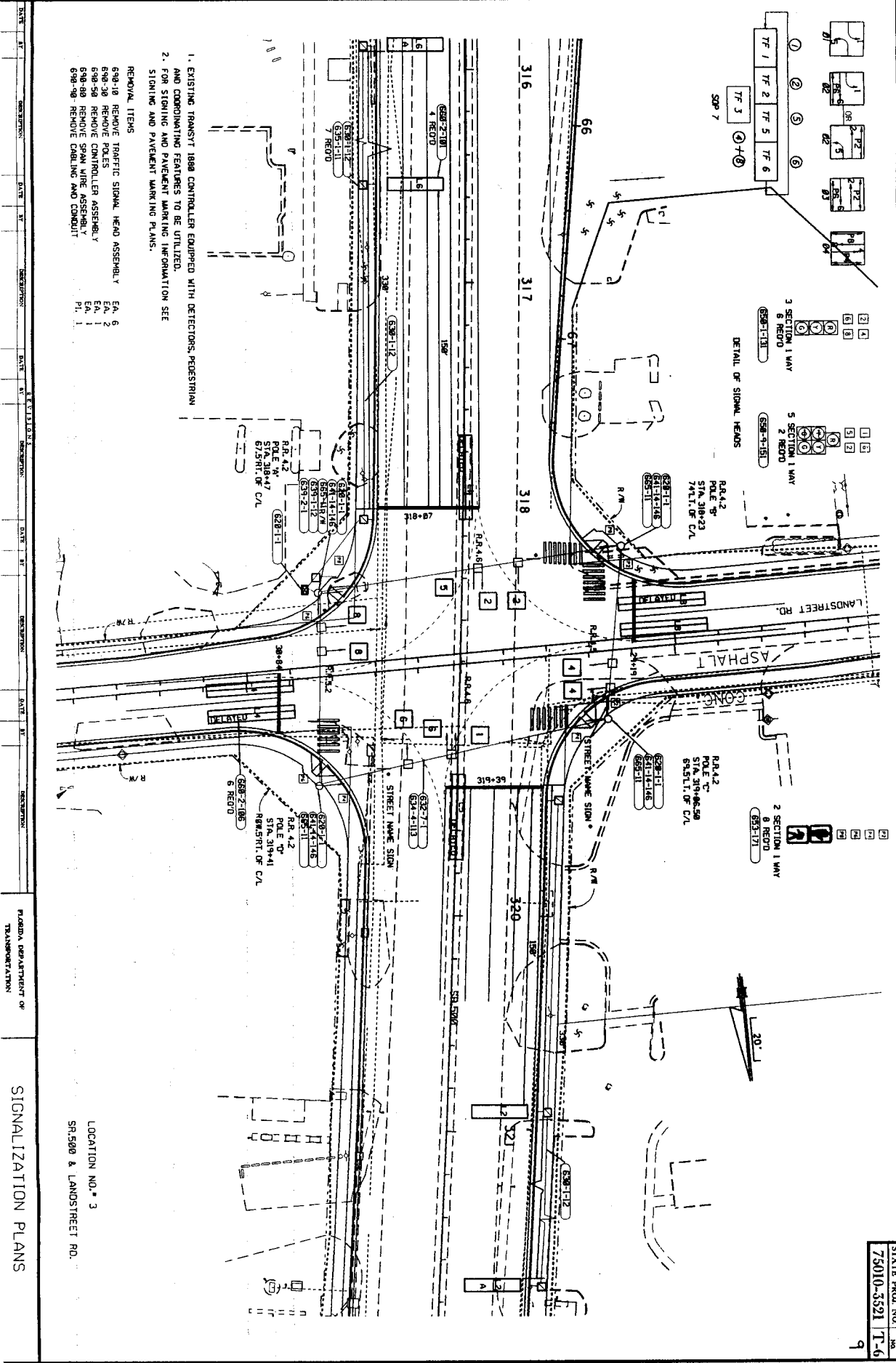

1. EXISTING TRANSYT 1888 CONTROLLER EQUIPPED WITH DETECTORS, PEDESTRIAN AND COORDINATING FEATURES TO BE UTILIZED.
2. FOR SIGNING AND PAVEMENT MARKING INFORMATION SEE SIGNING AND PAVEMENT MARKING PLANS.

- REMOVAL ITEMS
- 698-10 REMOVE TRAFFIC SIGNAL HEAD ASSEMBLY EA. 6
 - 698-30 REMOVE POLES EA. 2
 - 698-50 REMOVE CONTROLLER ASSEMBLY EA. 1
 - 698-80 REMOVE SPAN WIRE ASSEMBLY PL. 1
 - 698-90 REMOVE CABLE AND CONDUIT

DATE	BY	DESCRIPTION	DATE	BY	DESCRIPTION

FLORIDA DEPARTMENT OF TRANSPORTATION

SIGNALIZATION PLANS

STATE PROJ. NO. 75010-3521 T-6
SHEET 9

LOCATION NO. 3
SR 500 & LANDSTREET RD.