



**Interoffice Memorandum
COMMUNITY, ENVIRONMENTAL AND DEVELOPMENT SERVICES**

07-12-16P12:16 RC

July 7, 2016

07-12-16P12:09 RCVD

TO: Katie Smith, Manager
Comptroller Clerk's Office

THROUGH: Cheryl Gillespie, Agenda Development Supervisor
Agenda Development

FROM: Lori Cunniff, CEP, CHMM, Deputy Director
Community, Environmental and Development Services Department

STAFF PERSON: Elizabeth R. Johnson, Environmental Programs Administrator
Environmental Protection Division

PHONE #: 407-836-1511

SUBJECT: Request for Public Hearing on September 13, 2016, at 2:00 p.m. for a private Boat Ramp Facility Permit No. BR-15-05-000 – Island Grove Tree Farm, LLC, located at Chuluota Road, Orlando, FL 32820, on Lake Pickett, in Section 04, Township 22 South, Range 32, East, Parcel ID No.: 04-22-32-0000-00-025

NOTE: **Schedule this Public Hearing concurrently with the Conservation Area Impact permit application CAI-15-05-015**

Applicant: Island Grove Tree Farm, LLC.

Type of Hearing: Request for Private Boat Ramp Facility Permit.

Hearing required by Florida Statute No. or Code: Chapter 15, Article XV, Section 15-605(d)(2).

Advertising requirements: Publish once in a newspaper of general circulation in Orange County at least fourteen (14) days prior to public hearing.

Advertising timeframes: At least fourteen (14) days prior to the public hearing.

Abutters to be notified: The applicant will post with a notice of date and time of the public hearing on the subject parcel and notify the upland property owners within five-hundred (500) feet of the property line at least four (4) weeks prior to the public hearing.

Lake Advisory Board to be notified: Lake Pickett Advisory Board – Debra Parrish (DebraLParrish@gmail.com)

*Sept. 13, 2016
C 2pm*

July 7, 2016

Request for Public Hearing –Private Boat Ramp Facility for Island Grove Tree Farm, LLC.

Page 2 of 2

Estimated time required
For public hearing: 2 minutes.

Hearing Controversial: No.

Municipality or other
Public Agency to be
notified: Florida Department of Environmental Protection –
lisa.prather@dep.state.fl.us

District No.: 5.

Materials being submitted as backup for public hearing request:

1. Site Plans
2. Location Map

Special Instructions to Clerk:

1. Once the Board of County Commissioners makes a decision on the private Boat Ramp Facility, please submit the decision letter to Michelle Gonzalez with EPD. EPD will issue the decision to the applicant.

Advertising Language:

2. Island Grove Tree Farm, LLC (Parcel ID No.: 04-22-32-0000-00-025) requests to construct a private boat ramp facility (BR-15-05-000) pursuant to Chapter 15, Article XV. Lake Pickett. District 5. Legal description on file at EPD.

TMH/NT/ERJ/LC: mg

Attachments

c: Chris Testerman, Assistant County Administrator
Jon V. Weiss, P.E., Director, Community, Environmental and Development Services
Joel D. Prinsell, Deputy County Attorney

Private Boat Ramp Facility Permit Request

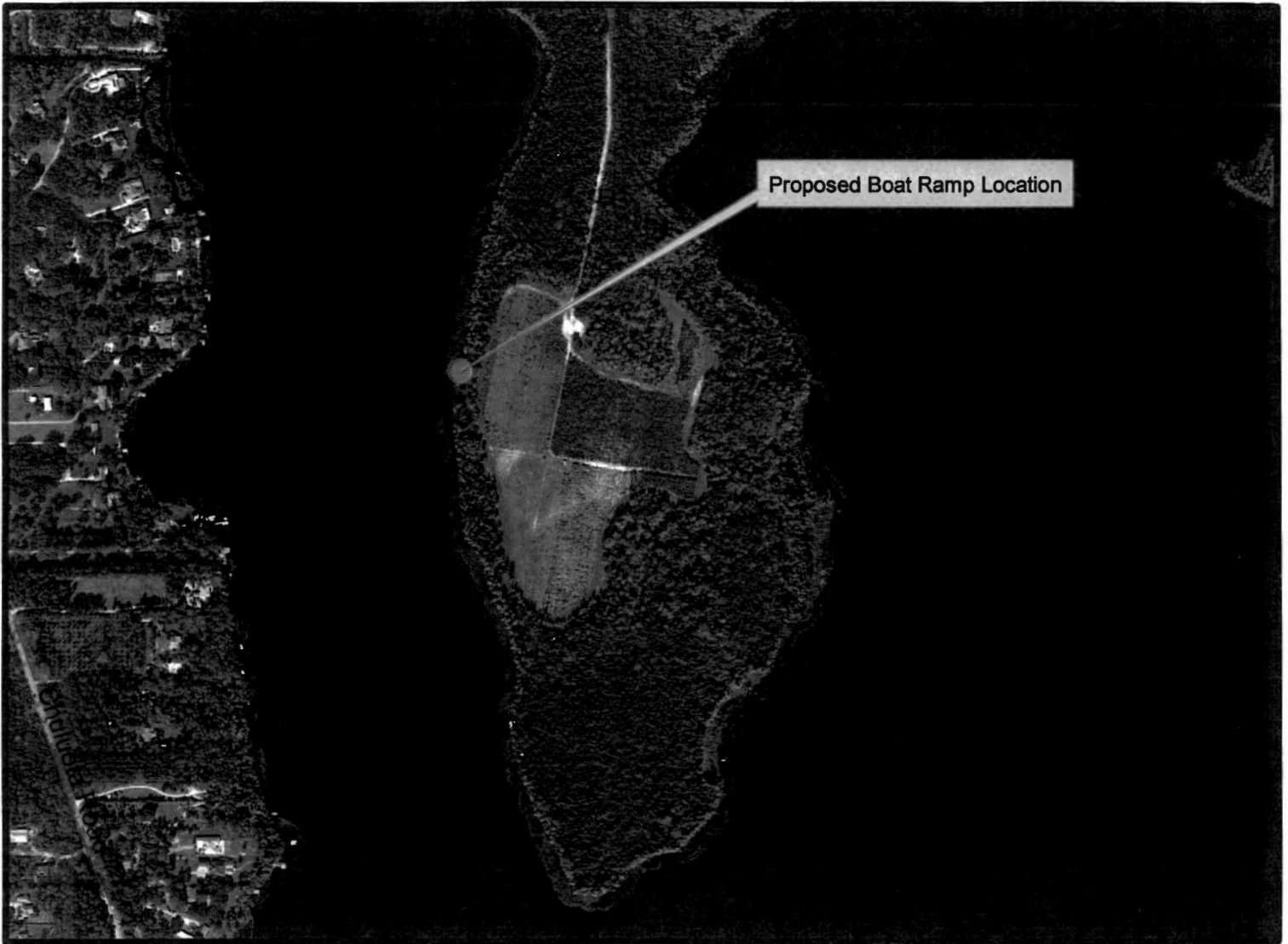

Private Boat Ramp Facility Permit Request

District No. 5

Applicant: Island Grove Tree Farm LLC

Parcel ID: 04-22-32-0000-00-025

Permit No.: BR-15-05-000

Project Site 

Property Location 

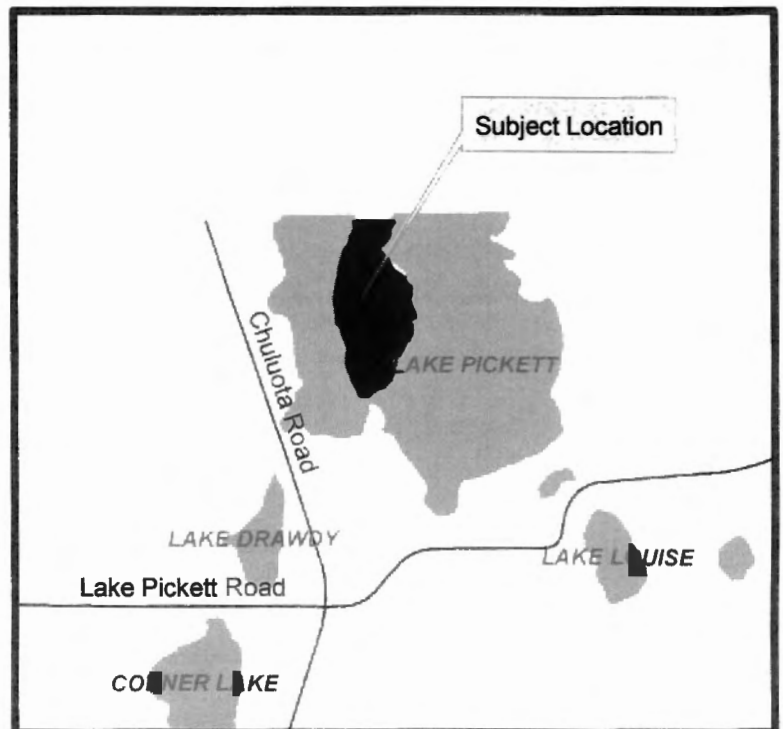

SITE CIVIL CONSTRUCTION PLANS FOR ISLAND GROVE BOAT RAMP CHULUOTA, FL

PREPARED FOR:
ALAN ASHLOCK
2727 LAKE PICKETT PLACE
CHULUOTA, FL 32766



AERIAL MAP
NTS

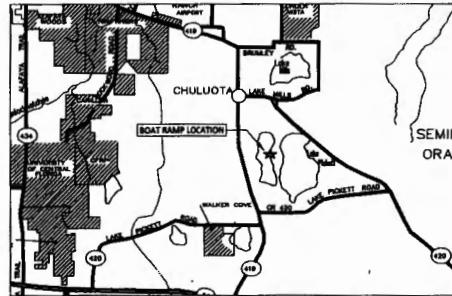

VACINITY MAP
NTS



SITE CIVIL SHEET INDEX

- C100 ——— COVER SHEET
- C101 ——— BOAT RAMP PLAN

RELATED PLANS BY OTHERS

- S100 ——— TOPOGRAPHIC & TREE SURVEY

PROJECT TEAM

OWNER/DEVELOPER

LAKE PICKETT REMODE, LLC
2727 LAKE PICKETT PLACE
CHULUOTA, FL 32766
PH: (407) 377-8888

CIVIL ENGINEER

HIGHLAND ENGINEERING, INC.
78 W. ALLAMBA ST.
ORLANDO, FL 32808
PH: (407) 375-7877

ISLAND GROVE BOAT RAMP	COVER SHEET													
		<table border="1" style="width: 100%; border-collapse: collapse;"> <tr> <th style="width: 5%;">REV.</th> <th style="width: 10%;">DATE</th> <th style="width: 85%;">DESCRIPTION</th> </tr> <tr> <td> </td> <td> </td> <td> </td> </tr> <tr> <td> </td> <td> </td> <td> </td> </tr> <tr> <td> </td> <td> </td> <td> </td> </tr> </table>	REV.	DATE	DESCRIPTION									
REV.	DATE	DESCRIPTION												

HIGHLAND ENGINEERING, INC.
78 West Allamba Street
Orlando, FL 32808
PH: (407) 375-7877
FAX: (407) 375-7877
Ct. No. 2767

JOB NO.: 09C-007
DESIGNED BY: *Janitor*
DRAWN BY: *Janitor*
APPROVED BY: *Janitor*
DATE: 4/20/2015
SHEET: **C100**

NOT FOR CONSTRUCTION
UNLESS SIGNED AND SEALED

[Signature]
JOSEPH W. BARNER, P.E.
REGISTERED PROFESSIONAL ENGINEER
DATE: 11/14/16

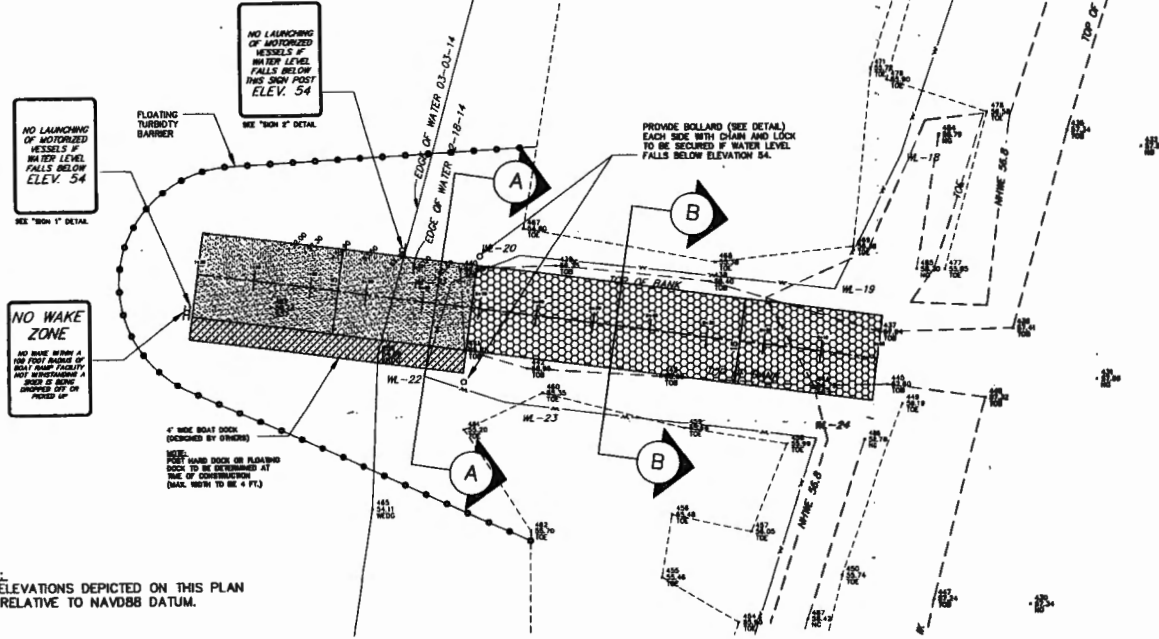

NOTE:
ALL ELEVATIONS DEPICTED ON THIS PLAN ARE RELATIVE TO NAVD88 DATUM.

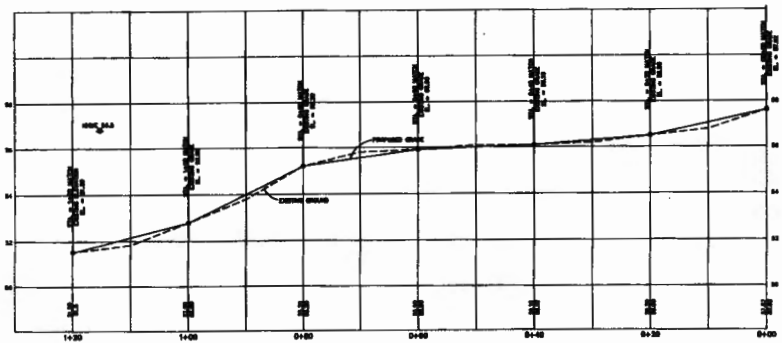

LEGEND / ABBREVIATIONS

	GRAVEL (SEE DETAIL)
	CONCRETE (SEE DETAIL)
TOE	TOE OF SLOPE
TOB	TOP OF BANK
NG	NATURAL GRADE
JWL	JOINT WETLAND
WEDG	WATERS EDGE
EL	ELEVATION
STA.	STATION
0+ ##	STATION NUMBER
x 55.00	EXISTING SPOT ELEVATION

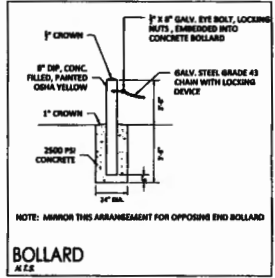
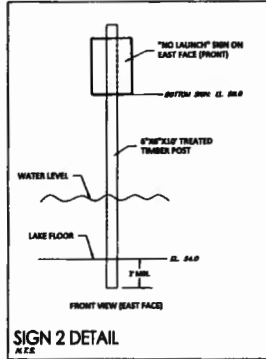
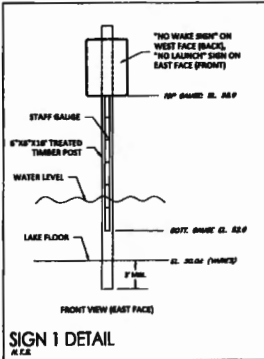
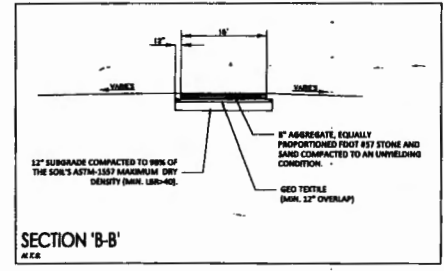
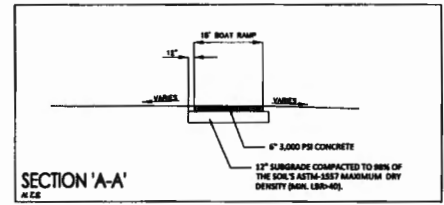

DATE	1/18/16
APP'D BY	
DESCRIPTION	ISLAND GROVE BOAT RAMP BOAT RAMP PLAN

ISLAND GROVE BOAT RAMP
BOAT RAMP PLAN

HEI
HIGHLAND ENGINEERING, INC.
28 West Street
Clemens, Florida 32009
Phone 407-226-2877
Fax 407-226-2877
Cell 407-226-2877

JOB No. C101-001
DESIGNED BY: [Signature]
DRAWN BY: [Signature]
APPROVED BY: [Signature]
SCALE: 1/2" = 1'-0"
SHEET: C101

NOT FOR CONSTRUCTION
UNLESS SHOWN AND SCALED
BY THE CONTRACTOR

REVISION No. 04122
DATE: 1/18/16