

**LEGEND:**  
 ECON TRAILS PROJECT BOUNDARY  
 APPROXIMATE WETLAND LIMITS PER BIO-TECH CONSULTING  
 APPROXIMATE WETLAND LIMITS PER ECON PLACE AND ECON PLACE II PD/LAND USE PLANS  
 APPROXIMATE LOCATION OF THE LITTLE ECONLOCKHATCHEE RIVER  
 UPLAND BUFFER  
 APPROXIMATE CONSERVATION EASEMENT PER ORB 10013 PG 7998

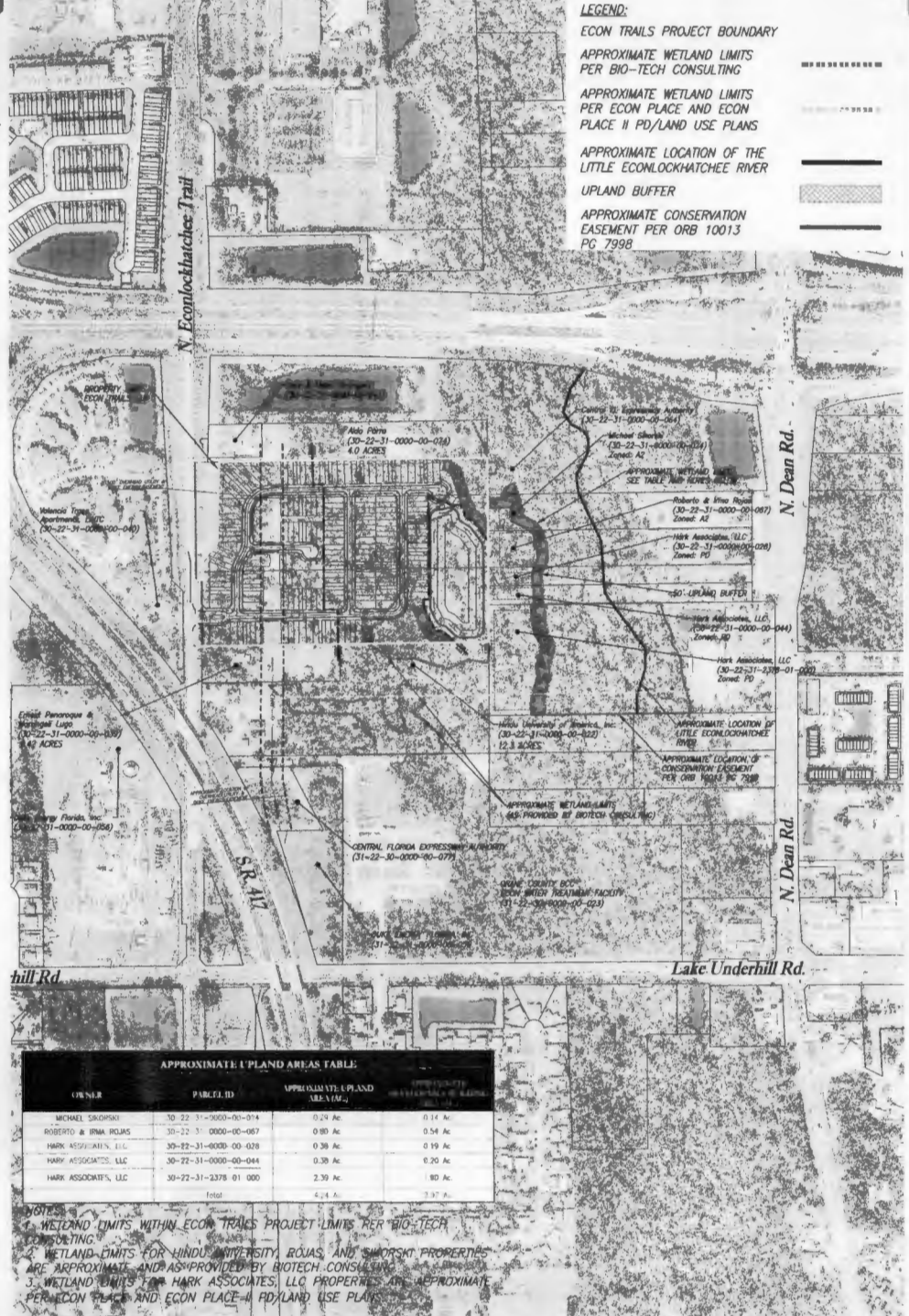

APPROXIMATE UPLAND AREAS TABLE

OWNER	PARCEL ID	APPROXIMATE UPLAND AREA (AC)	APPROXIMATE WETLAND AREA (AC)
MICHAEL SKOWRONSKI	30-22-31-0000-00-014	0.24 Ac.	0.14 Ac.
ROBERTO & IRMA ROJAS	30-22-31-0000-00-067	0.80 Ac.	0.54 Ac.
HARK ASSOCIATES, LLC	30-22-31-0000-00-028	0.38 Ac.	0.19 Ac.
HARK ASSOCIATES, LLC	30-22-31-0000-00-044	0.38 Ac.	0.20 Ac.
HARK ASSOCIATES, LLC	30-22-31-1378 01 000	2.39 Ac.	1.80 Ac.
Total		4.44 Ac.	3.37 Ac.

- NOTES:
1. WETLAND LIMITS WITHIN ECON TRAILS PROJECT LIMITS PER BIO-TECH CONSULTING.
  2. WETLAND LIMITS FOR HINDU UNIVERSITY, ROJAS, AND SMOORNT PROPERTIES ARE APPROXIMATE AND AS PROVIDED BY BIOTECH CONSULTING.
  3. WETLAND LIMITS FOR HARK ASSOCIATES, LLC PROPERTIES ARE APPROXIMATE PER ECON PLACE AND ECON PLACE II PD/LAND USE PLANS.

Vicinity Map

**Econ Trails**

